

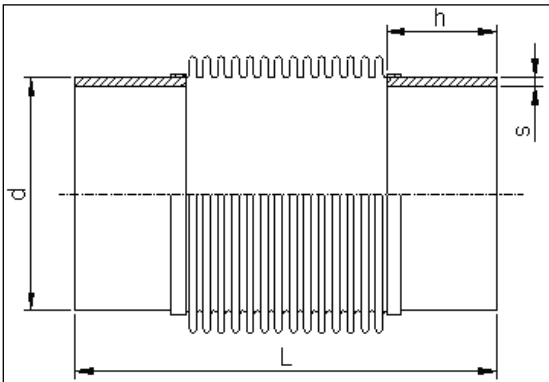

Axial expansion joints in AISI 321, without inner liner, with weld ends in carbon steel.

We can supply other materials for bellow and weld ends too.



Fluid: Water

Other: fluids on request.

Operating pressures:

DN25 bis DN50 = 16 bar

DN65 bis DN100 = 10 bar

DN125 = 8 bar

DN150 = 6 bar

D200 bis DN250 = 4 bar

Other dimensions, higher pressures on request.

We supply also other dimensions.

DN	inch	L Movement 30 [mm]	Code- number	L Movement 60 [mm]	Code- number	d [mm]	s [mm]	h [mm]
25	1"	180	WE-DN25-180-30			33,7	2,3	45
32	1 1/4"	185	WE-DN32-185-30			42,4	2,3	45
40	1 1/2"	190	WE-DN40-190-30			48	2,3	50
50	2"	185	WE-DN50-185-30			60	2,3	50
65	2 1/2"	185	WE-DN65-185-30	240	WE-DN65-240-60	76	2,6	50
80	3"	185	WE-DN80-185-30	245	WE-DN80-245-60	89	2,9	50
100	4"	200	WE-DN100-200-30	265	WE-DN100-265-60	114	3,2	60
125	5"	200	WE-DN125-200-30	265	WE-DN125-265-60	139	3,6	60
150	6"	245	WE-DN150-245-30	315	WE-DN150-315-60	168	4,0	80
200	8"	265	WE-DN200-265-30	340	WE-DN200-340-60	219	5,0	80
250	10"	310	WE-DN250-310-30	395	WE-DN250-395-60	273	5,0	100

Changes are possible without notice